

## iSmart auto Wireless CarPlay

Factory direct sales ·  
Non-destructive installation ·  
Original car upgrade ·  
Continuous upgrade service ·

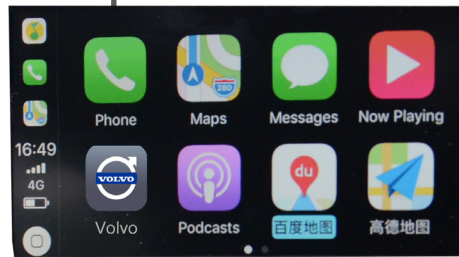

## iSmart auto Wireless CarPlay & Android Auto Smart Module

Product Manual For Volvo XC70 XC60 S60 V40 V60 V70

Factory direct sales · Non-destructive installation · Original car upgrade · Continuous upgrade service

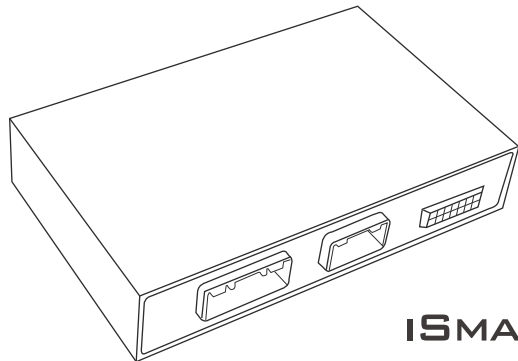

**iSMART AUTO BOX**  
Wireless CarPlay Smart Module

## 1. Packing List



1 iSmart CarPlay Main Box



2 48PIN Connector



3 LVDS Cable



4 USB & Video Cable



5 Antenna Cable x 2



6 Audio USB-AUX cable (Optional)

## 2. Function introduction



CarPlay



CarLife



AndroidAuto



Front/Rear/360



Mirroring

AHD

AHD HD video protocol



USB video



DSP Power amplifier chip

### • CarPlay

The iPhone's built-in car-machine interaction system works with the central control knob button to operate the voice control phone, information, navigation, music and Siri voice interaction for more information; supports wireless and wired connections to CarPlay

### • CarLife

The car and machine care system developed by Baidu, supports the connection of iPhone and Android devices, voice control of telephone, information, navigation, and music; built-in "Xiaodu" voice control system, supports wireless and wired connections

### • AndroidAuto

The original ecological Android car-machine interaction system developed by Google, voice control phone, information, navigation, music built-in voice control system;

### • Front/Rear/360

The intelligent module can decode video, and can be equipped with front view, rear view (support display intelligent dynamic trajectory and radar), right view and 360 panoramic view

### • Mirroring

Supports wired and wireless screen projection for iPhone and Android phones

### • AHD HD video protocol

Added AHD HD rear view/360 video output interface

### • USB video

Automatic media playback function, can directly insert U disk to play audio and video media

### • DSP Power amplifier chip

Add DSP power amplifier chip to improve sound quality

## 3. Connection Diagram

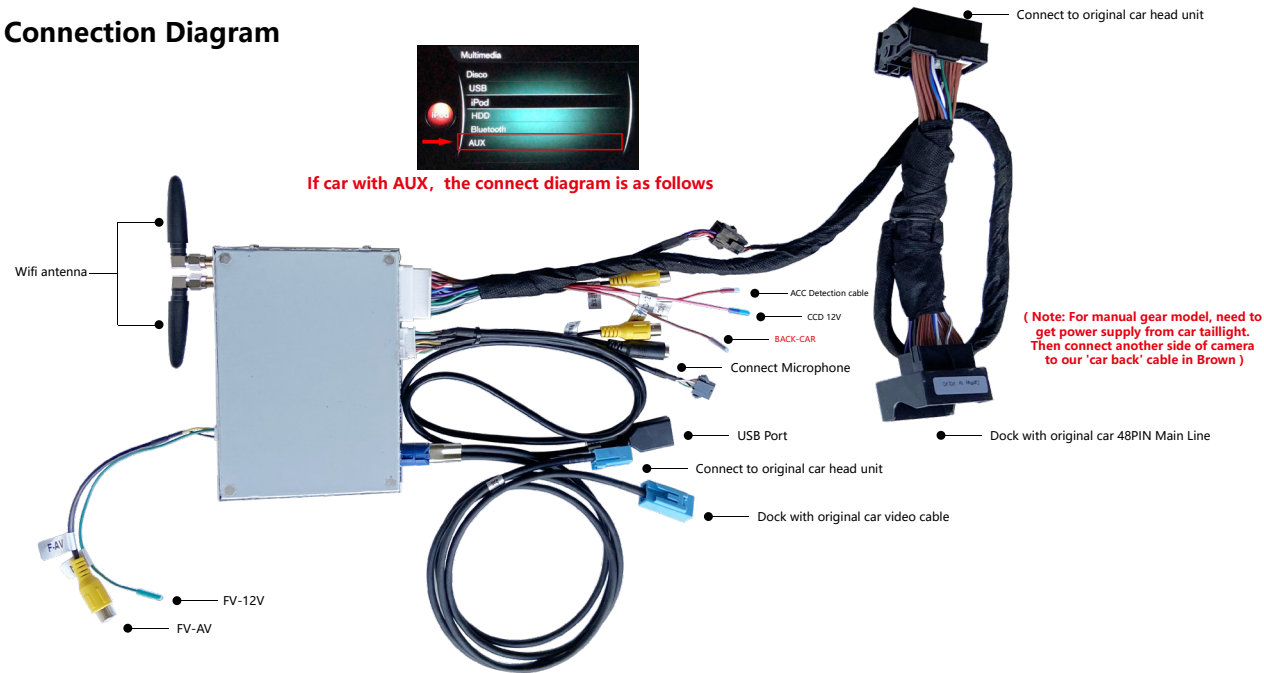

If car without AUX, the connect diagram is as follows

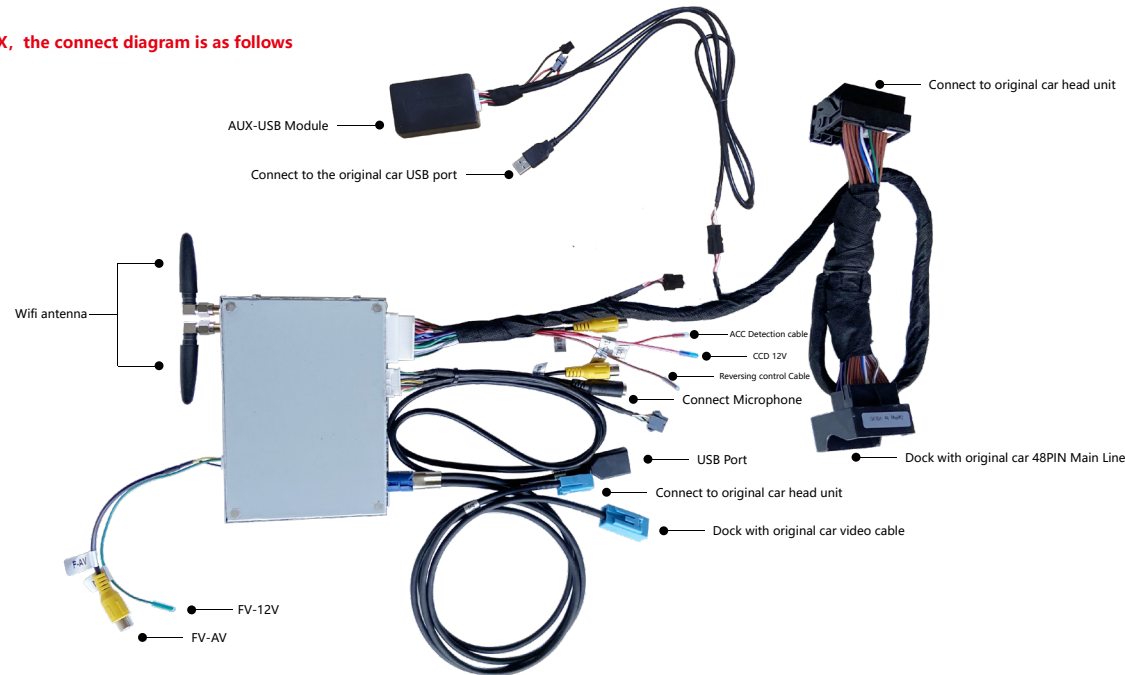

## 4. Main Parameters & Specifications

Operating voltage: 9-16V, 14.4V (rated)	Storage temperature: -30~+85°C
Operating temperature: -30~+75°C	Ambient humidity: ≤98% (at45°C) , 65±5% (rated)
Power consumption current: 1A (rated) , 3A (Max)	Shutdown current: Current: 300mA (Clock is on)
Quiescent current: less than 3mA	
Charging current: ≤2A, when the USB charging current >1A, the host machine should activate the circuit protect function to control the current within 1.5A and avoid products burning	

## 5. Warranty Terms

Dear user:

Thank you for using our products. In order to makesure customers receive product is good, all our products have been strictly tested in our factory before delivery. And all our products enjoy 1 year warranty.

### But following conditions are not covered by warranty:

1. Warranty period over; the apperance with scratches dirt, deformation.
2. Information on Warranty car and purchase bill inconsistent with product, or modified.
3. There is no bar code or bar code not clearly on host unit.
4. Damage caused by using, disassembling or refitting product not follow the instruction properly.
5. Not our company authorized personnel disassemble. repair or refit to cause human made damage.
6. The product damaged by improper transport orimproper use.
7. Damage due to irresistible factors (such as fire, flood, traffic mattersTherefore, lightning, earthquakes, etc.).

## 6. Interface introduction

Music: Play local music in USB, formats include: MP3, WMA, AAC, AC3, DTS, OGG, FLAC, APE, AMR.



CarPlay: Support iPhone wired and wireless CarPlay connection (The connection method can be set by yourself)



Bluetooth: You can view the Bluetooth name and pairing code in this interface



Video: Play local video in USB, the format includes: mkv, mp4, avi, wmv, rmvb, mmpg, mpeg, ts, dat, asf, flv, vob.

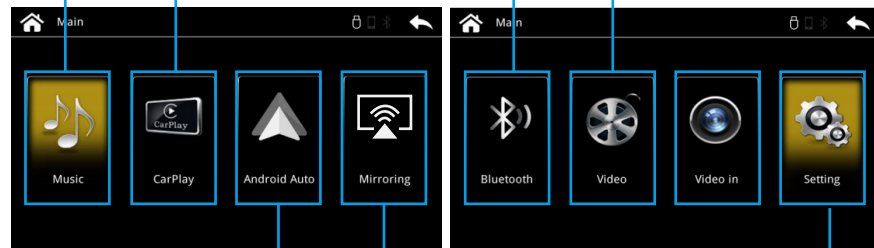

CarLife: Support Android mobile phone wired and wireless CarLife connection (connection method can be set by yourself)

Android Auto: Support Android Auto connection of Android phones

Note: To use CarLife or Android Auto, you need to enter the system setting selection



Mirroring: Support mirrored screen projection for iPhone & Android phones



Setting: System setting interface, setting entrance of system functions

## 7. Button description

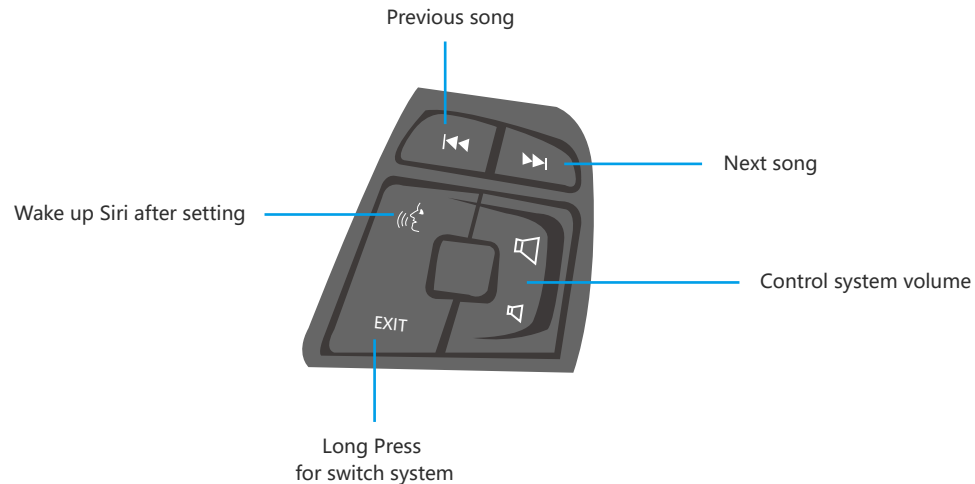

## 8. Installation Process

### Tools you need to prepare

- 1 \* panel remover
- 1 \* T20 screwdriver
- 1 \* T10 screwdriver(some car models need it to dis-assembly the glovebox)
- Tape and towel-protect the trim and panel, collect harness

**Remark : Make Sure Car Engine Off Before The Installation. Open/Close The Driver Side Door ONCE, Wait Centre Screen Turns Black**



1. Remove the air-conditional panels and trim via plastic panel remover. (Note to disconnect the connector behind the panel)



2. Unscrew the 2 screws at the corner



3. Remove the whole console control panel



4. There are 2 screws on multimedia head unit, unscrew them and take out the box

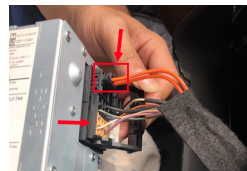

5. Remove the 48pin connector cable, Note: If there is FIBER cable on original 48pin connector, please remember to remove it.

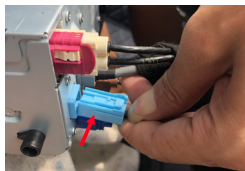

6. Remove the LVDS cable (normally blue one)

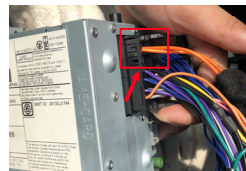

7. Insert the iSmart box 48pin connector into multimedia head unit. Insert the original FIBER cable into iSmart 48pins connector.

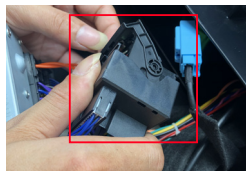

8. connect its another side with original car 48pin connector

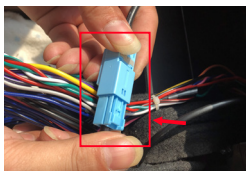

9. Connect iSmart LVDS cable with original car LVDS cable

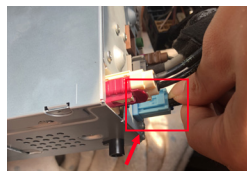

10. Insert another side into multimedia head unit



11. Put all harness through the ACC area to passenger glove box area. Recommend you put iSmart box here

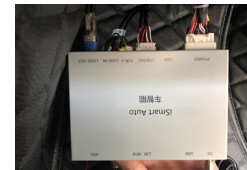

12. Connect the power cable, LVDS cable, and USB cable with iSmart box



13. Insert the audio USB-AUX cable into car USB port.(if original car have AUX, omit this step)



14. The installation is finished, put back all panels. Long press EXIT button on the wheel to switch to carplay interface

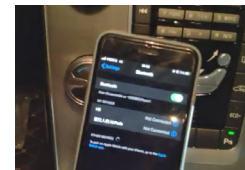

15. Open the phone Bluetooth, and keep WIFI on

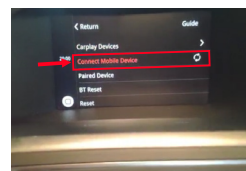

16. Enter the WireleeDev interface, click connect mobile phone device

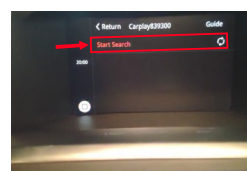

17. Searching your phone



18. Phone will ask you whether to use carplay, please choose allow. Carplay connection successes

### Voice Setting



1. Insert the audio USB cable into car USB port.(if original car have AUX, omit this step)



2. Enter into Media interface on car original system



3. Choose iPod. (If original car have AUX, choose AUX; )



4. Long press EXIT button on the wheel to switch to carplay interface



5. Enjoy wireless Carplay after connect your phone.

## 9. Wireless CarPlay Connection Method



1. Long press the EXIT button of the original car to switch to the CarPlay main system interface, find the Bluetooth function option and click to enter



2. Check the Bluetooth name of CarPlay on the "Bluetooth" system interface



3. Turn on the phone WiFi and keep it turned on, then enter the phone Bluetooth interface, click and connect CarPlay Bluetooth



4. Click on the Bluetooth name beginning with the link "Car Audio\_", a pairing request will pop up, just click on pairing; after the Bluetooth pairing is successful, the phone will pop up a request to enable the carplay option, click on confirm.

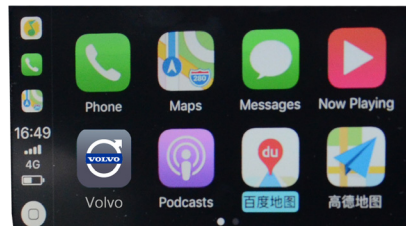

5. CarPlay connection is successful, you can use wireless CarPlay

## 10. Android auto Connect Method

Before connecting to use Android Auto, you need to download and install Android Auto App on your phone in advance



1. Long press the EXIT button of the original car to switch to the "CarPlay" main system interface, find the "Bluetooth" function option and click to enter

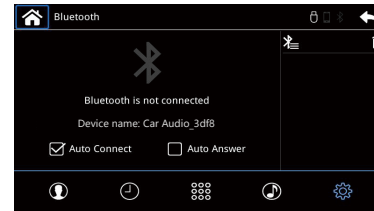

2. In the Bluetooth interface of CarPlay, you can view the Bluetooth name and pairing code of CarPlay; check Auto Connect, the next time you get in the car, the Bluetooth of the phone will automatically connect

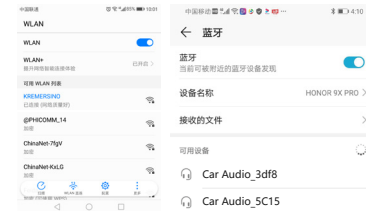

3. Turn on the phone WiFi and keep it turned on, then enter the phone Bluetooth interface, click and connect CarPlay Bluetooth

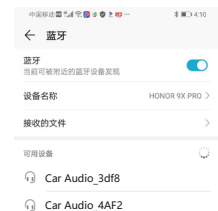

4. Click on the Bluetooth name beginning with the link "Car Audio-", a pairing request will pop up, just click on pairing;

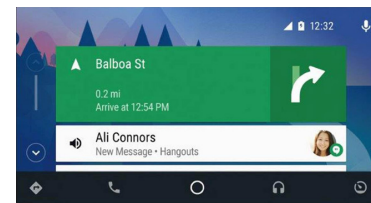

3. After the Bluetooth connection is successful, it will automatically connect to Android Auto. After entering the Android auto page, the system supports the original car touch or knob and other corresponding buttons to seamlessly operate the Android auto page APP

## 11. iPhone Wireless Mirroring

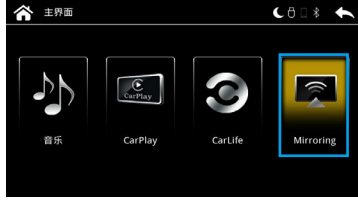

1. Long press the EXIT button of the original car to switch to the "carplay" main system interface, find the "Mirroring" function option and click to enter



2. Select iPhone option in Mirroring function



3. Take out the iPhone, find the "Wireless LAN" function option and enter; open the "Wireless LAN" function option, then the carplay-wifi name will appear in the search bar and click on this wifi, the password is 88888888

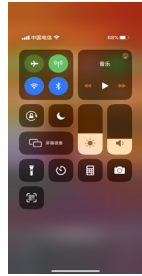

4. After the carplay wifi connection is successful, the phone returns to the main interface, opens the shortcut menu bar, selects "Screen mirroring" and opens



5. After the mobile phone "Screen mirroring" is turned on, select "Mirroring" to complete the wireless projection

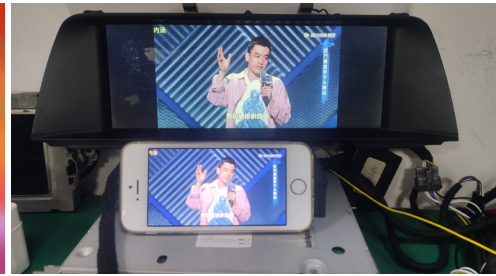

## 12. Android Wireless Mirroring

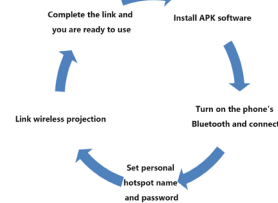

1. To use Android wireless mirroring, you need to download a "MLink" software first, and you can obtain the "Android wireless APK software" from the dealer

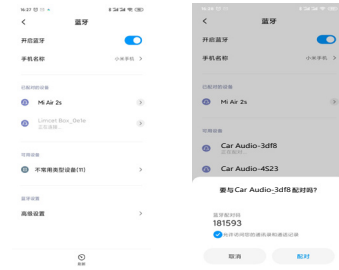

4. Take out the Android phone, find the "Bluetooth" function option, and find the name starting with "Car Audio-" in the Bluetooth search bar, click connect; click the link "Car Audio-" starting with the Bluetooth name, a pairing request will pop up, click pairing

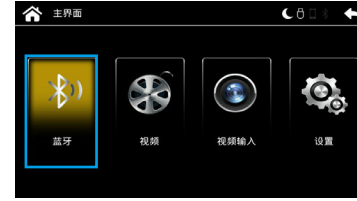

2. Long press the EXIT button of the original car to switch to the main system interface of "CarPlay", find the "Bluetooth" function option and click to enter



3. Check the Bluetooth name on the "Bluetooth" system interface

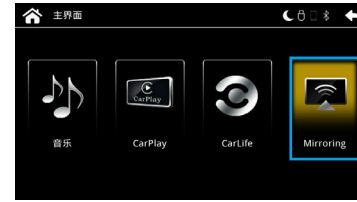

5. Long press the EXIT button of the original car to switch to the main system interface of "CarPlay", find the "Mirroring" function option and click to enter



6. Select the "Mirroring" function option and adjust it to "Android" to prompt the phone to establish a mobile hotspot for communication. The hotspot name and password are displayed in the lower left corner of the connection interface



7. Enter the phone settings function and find "Personal Hotspot";

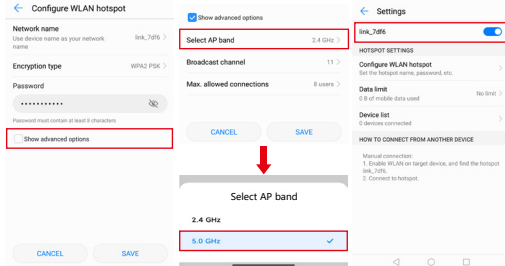

8. Set the name and password of "Personal Hotspot" to be consistent with the name and password prompted on the "Mirroring" interface.  
Select "5.0 GHz Band" for the hotspot AP band; (If there is no such option, check the "Show advanced options" first)  
Then save the setting and turn on the "Personal Hotspot" switch

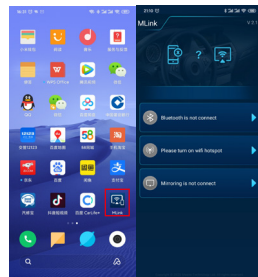

9. Return to the main interface of the phone and open "MLink" to use wireless mirroring

## 13. Camera settings

CarPlay System - Setting - Car Setting - Reversing camera

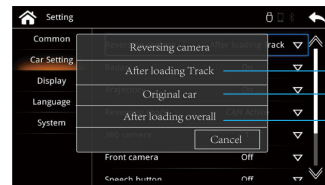

Please select this if you install a camera

Please select this if the original car with a camera

Please select this if you install 360 camera

CarPlay System - Setting - Car Setting- Radar

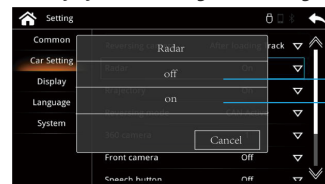

The radar is not displayed on the interface of the camera select this option

The radar is displayed on the interface of the camera select this option

CarPlay System - Setting - Car Setting - Trajectory

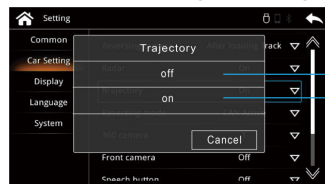

If the camera interface does not display dynamic track, select this option

If the camera interface display dynamic track, select this option

## 14. Echo cancellation

### CarPlay System - Setting - System

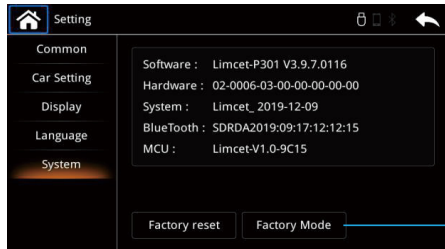

Enter the password "8818"  
Click "OK" to enter factory mode

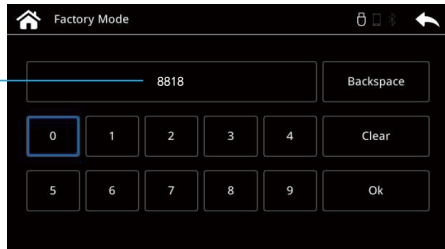

Enter Factory Mode

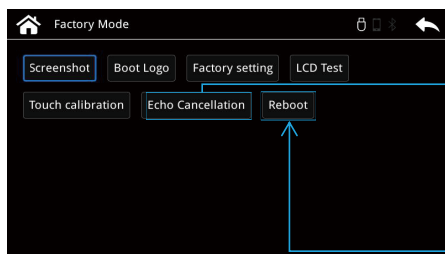

Call echo cancellation button,  
if the call has echo,  
please enter this button to  
perform echo correction

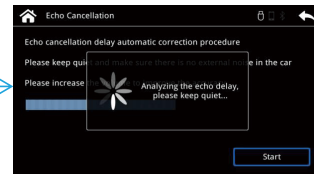

Analyzing the echo delay finished,  
noise accuracy:91%!  
the volume to improve the accuracy  
Analysis failed, please try again!

After the steps are completed in sequence,  
click the button to return to the left interface  
Click the "Reboot" button to restart the system,  
wait for the system restart to complete,  
the selected settings take effect

**When correcting the echo, you must keep:**  
1. The environment in the car is quiet;  
2. The sound channel must be set to the AUX channel  
that the system can recognize;  
3. Turn the volume to a moderate position,  
then click "Start" to start echo correction,

**The larger the final correction value, the better,  
as shown on the left**

## 15. iPhone / Android Phone Setting

### CarPlay System - Setting - System - Factory mode - Factory setting

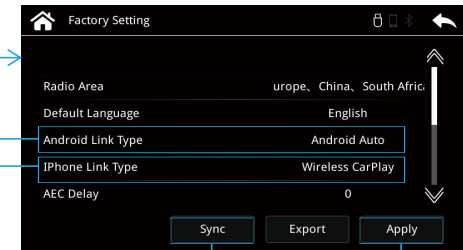
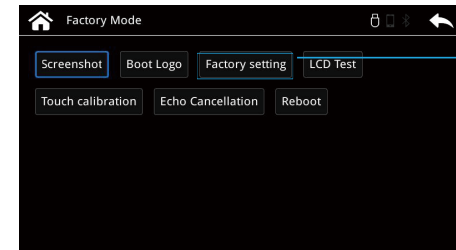

Android phone interconnection is off  
Baidu CarLife interconnected  
GooglePlay interconnected

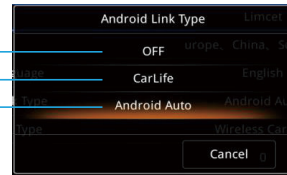

iPhone CarPlay interconnected is off  
iPhone CarPlay wired connection  
iPhone CarPlay wireless connection



After the setting is complete, you need to click Apply-Sync, and then return to the interface below, click Reboot to restart the system, and wait for the system to restart, the selected settings will take effect

